

# NEWSLINE

27 JANUARY 2017  
ISSUE 391



## Queen Street Upgrade set to begin

On 7 February 2017, the largest capital project ever carried out in Tasman District will begin – the multimillion-dollar Queen Street Upgrade.

The upgrade is driven by the growing and changing demands on Richmond's infrastructure. Extreme weather events, a rapid increase in population and evolving dynamics within the town (once a rural service centre that is increasingly being looked to as the retail heart of a thriving urban area) have all thrown an added burden on the spine of services that run beneath the commercial heart of Richmond – Queen Street.

Our contractor, Hawkins Infrastructure, will dig up Queen Street to install larger water, wastewater and stormwater pipes. The water services were developed more than 50 years ago. They have lasted well but are no longer coping with the amount of water they need to carry.

The surface of the street will be replaced from shop front to shop front with the centre of the street lowered to better control floodwaters.

In both 2011 and 2013, Richmond was hit by major floods. Properties on Queen and Oxford streets were inundated with water, which flowed towards buildings from the slightly-raised crown of the road.

### Meet Chris Forman

If you have a question about the project, Chris is your go-to guy. He is the Hawkins Community Relations Office Manager for the project, and will be responsible for liaising directly with businesses, stakeholders and the general public to resolve any queries or issues you may have. Chris has come directly from working for Hawkins on the Christchurch Rebuild, so has a great understanding of complex construction projects and the implications they can have for those affected. You can find him at the Hawkins office at 272 Queen Street. Contact Chris: Phone 0800 000 413.



**Chris says: "In my experience having one 'go to' person for those affected by construction activities works really well. As my title says I am about ensuring positive relations exist so the project causes the least disruption possible."**

[READ MORE ABOUT THE QUEEN STREET UPGRADE ON PAGE SIX](#)

## Mayor's message

Welcome to 2017! It's great to have started the year with so much enjoyable activity in the region. There is a fantastic programme of summer events planned for Tasman and Nelson and I hope that you are all able to take some time to enjoy some of the wonderful activities in our district.

Summer is always a busy time for our district, but it's interesting to note the significant increase in visitors this January. Individuals and organisations have been assisting those affected by the eastern earthquakes, but it is noticeable to observe visitors who have redirected their trips from Kaikoura. We've had reports of a substantial increase in traffic through St Arnaud, Murchison and Springs Junction and while this has created a lift in economic activity in those areas and the district, the dramatic increase in traffic has had a significant impact on local residents. Thanks to the NZ Transport Agency who have worked with us and the Murchison and St Arnaud communities to address issues that are identified. We're also seeing a notable increase in residential development in parts

of the district, which again brings economic benefits but places increasing pressure on the Council and developers.

So, there's lots of good stuff happening in our district and I wish everyone a happy and prosperous New Year.

**Mayor Richard Kempthorne**



## Summer Rides for a wheel good time

### Golden Bay Bike Fun

Sunday 12 February, 11.00 am at Golden Bay Recreation Park.

Includes a bike skills course, decorate your bike, slow bike race and Bike Tune Ups.

### Go By Bike Day Breakfasts

Wednesday 15 February, 7.30 am – 9.00 am.

If you bike in the morning, stop by for a free breakfast snack and spot prizes.

### Go By Bike Day venues:

- Takaka – The Quiet Revolution
- Motueka – Museum
- Nelson – 1903 Square
- Richmond – Sundial Square (includes Bike Check and Tune Up)



### Motueka Bike Fun

Sunday 19 February, 11.00 am at Thorp Bush.

Explore the Motueka bike paths, ride the skills course, decorate your bike, slow bike race and Bike Tune Ups.

### Aotearoa Bike Challenge February 2017

It's all about participation – which workplaces can get the most people to ride a bike for just 10 minutes or more? Organisations across the country will compete against each other to see who can get the most staff to ride a bike during the Challenge (1-28 February). Register at [www.aotearoa.bike](http://www.aotearoa.bike).



# Workshops for sustainable living at home

There are lots of different ways you can trim household expenses and make the best use of resources. Workshops will include a presentation from an experienced speaker, followed by small-group practical experiences and activities to try at home.

## When and where

Sessions held weekly on Wednesday, 7.00 pm – 9.00 pm.

Richmond Library – Constance Barnicoat Room.

- 1 March: Introduction to best use of resources

- 8 March: Loving food – effective shopping, storage, preserving, wild foods
- 15 March: Growing food – choosing what and when to plant, composting, worms and long-term maintenance
- 22 March: Water – ways to conserve water, how to change a washer, find out about rain harvesting.
- 29 March: Energy efficiency – many ways to save power, keeping the home warm or cool, transport options
- 5 April: Loving your wardrobe – clothes swap, mending and other creative options and arranging more get-togethers

## Secure your spot

Enquire at Richmond Library or phone (03) 543 8500.

---

## Water saving tips

Please take care with your water use. We cannot always rely on getting rain and having the 'shared water tanks' full. Save water and reduce waste with these handy tips.

### Outdoors

- Repair leaky taps, hoses or fittings.
- Consider capturing rain water in an outside tank to use on the garden.
- Water the garden during the cool morning or evening to minimise evaporation.
- Soak or drip hoses are more efficient to directly water the garden soil and plant roots.
- Use mulch on gardens to help retain moisture in the soil.
- Hand held hosing means you can more easily monitor plant health.
- If using a sprinkler, ensure water is not wasted watering the concrete paths. Do not leave sprinklers or hoses unattended.
- Clean driveways and cobwebs off the house with a broom rather than a hose.
- Use a small bucket of soapy water to clean your car, boat or bike and only use the hose to quickly rinse off. Ensure any soapy water only goes on to the lawn or runs off on to a garden, not down any outside drains, which take water directly to a nearby stream.
- Choose garden plants that require minimal water and plant in ways that

will keep the soil shaded from the sun as much as possible.

### In the laundry

- Make sure every load in the washing machine is a full one.
- If you must wash small loads, use the lowest water level the machine provides.
- Use the 'suds-saver' feature if your machine has one. It reuses warm, soapy water.
- Use water emptied through your washing machine hose to water the flower garden and trees.
- Repair leaky taps, hoses or fittings.
- Minimise running water from the tap to rinse items – use a bowl instead.

### In the bathroom and toilet

- Keep your showers short. A three-minute shower can use less than half the quantity of water needed for a bath.
- You can keep a bucket in the shower to collect water for your garden and trees.

- Install low-flow shower heads or a volume control valve.
- Minimise water use when cleaning your teeth. Turn the tap off when brushing.
- Install a dual-flush toilet. You save five litres when you use the half-flush.
- Repair leaky taps or fittings.

### In the kitchen

- Minimise running water from the tap.
- Repair any leaky taps.
- Wash vegetables or rinse dishes in a bowl of water, not under a running tap.
- Make sure automatic dishwashers are full. If buying a dishwasher, get one that uses less than 25 litres of water per wash.
- Store drinking water in large jugs or bottles in the refrigerator rather than letting the tap run every time you want a cool glass of water.
- When cooking vegetables, use just enough water to cover them and use a tightly fitting pot lid, steam them, or use a microwave oven.



## How we can help keep stock out of waterways

Excluding livestock from waterways provides significant water quality benefits. In recognition of this, the Council has rules on discharges from livestock entering waterways. The dairy industry, with support from Council, has also put in place the Dairy Accord setting standards by which the industry operates.

Future amendments to the Resource Management Act are proposed to contain specific stock exclusion provisions. Until those amendments become law, the Council does have a solution.

### Funding for fencing

Our River and Stream Management Fund provides advice and financial support for the protection and enhancement of waterways by fencing out stock. Funding includes providing landowners with fencing materials for approved works, riparian planting and management advice.

### Why exclude stock from waterways?

Fencing waterways to exclude stock creates riparian buffers and is the single most effective measure for reducing faecal contaminant and sediment loads in streams. Establishing grasses, trees and shrubs within riparian zones can further reduce contaminant loads and improve stream ecology by providing shade, habitat and a food source for native fauna. Other benefits include:

- Greater bank and drain stability
- Improved pasture and stock management
- Fewer stock losses

### Fencing Fund quick check

The chart below will give applicants an idea of how important it might be to fence the waterways on their properties from stock. Please note that this tool is a guide and an onsite assessment will be necessary.

- For each factor, add up the values that most closely resemble your waterway. If your score is 10 or greater, please consider contacting us to ask about the River and Stream Management Fund.

### Notes

- Approved works must contribute to the stability or health of the catchment system as a whole.
- The landowner or occupier accepts responsibility for erecting and maintaining fencing works to a required standard.
- Funding is not available for boundary fences, or where legislation or other agreement, including the Sustainable Dairying Accord, rules set out in the Tasman Resource Management Plan or resource consent conditions require fencing.

**For more information contact Bernard Simmonds (Resource Scientist – Land):**  
[bernard.simmonds@tasman.govt.nz](mailto:bernard.simmonds@tasman.govt.nz)  
**Ph. 03 543 8446**



Factor	Level		
Stock type	Sheep/other (2)	Deer (3)	Cattle (5)
Risk of streambank erosion	Minimal (1)	Low/Mod (3)	High (5)
Slope of surrounding landscape	Flat (1)	Gentle (2)	Hilly (3)
Water flowing or present year round	No (2)	Yes (4)	

# Motueka Community Board By-election

It's time to vote!

Eligible Motueka Ward voters are able to cast their votes in the 2017 Motueka Community Board By-election until Friday 17 February 2017.

Voting papers are being mailed to registered voters until Tuesday 31 January. People who have not received their papers by 31 January should contact Sandra Hartley, Electoral Officer, on 03 543 8554 or 03 528 2022.

Special voting facilities will be available until Friday 17 February at our Richmond office during normal office hours, and our Motueka office between 10.00 am and 12 midday on Wednesdays and Fridays from 1 February until 17 February.

If you require special voting documents, they can also be posted out to electors by telephoning the Electoral Officer on 03 543 8554 or 03 528 2022.

The Motueka Community Board By-election will use the First Past the Post voting system to elect one member. Voters are required to put a tick alongside the candidate they wish to vote for. The voting papers will have clear instructions on how to vote.

Voting documents must be received by the Electoral Officer by 12 noon on Friday 17 February 2017. This is a postal vote, but votes will be accepted in the ballot boxes at Tasman District Council offices in Richmond and Motueka up until the close of voting.

## Good accessibility equals good business

Accessibility not only means access for people with disabilities; it includes access and usability for customers with strollers, visual or hearing impairment, progressive conditions such as arthritis and those with sports injuries etc.

Accessible or 'barrier free' design ensures efficiency, comfort and convenience for everyone. It is a practical matter and not an emotional issue.

The Accessibility for All Forum has a handy self-assessment checklist for businesses that contains some good tips to make business premises more accessible for people using wheelchairs.

For more information or to download the checklist, search [tasman.govt.nz](http://tasman.govt.nz) for 'good access'.

### Got a wheelchair for use?

The Accessibility for All Forum is also updating its list of businesses that have a wheelchair available for use. If you would like to be included on the list, please email [dana.wensley@tasman.govt.nz](mailto:dana.wensley@tasman.govt.nz).



Subsidised dog neutering is available

## Government support gained in the control of menacing dogs

We are now in a position to provide subsidised neutering of menacing dogs.

In September 2016 Hon Louise Upston, Associate Minister of Local Government, announced \$850,000 in Government funding for a nationwide neutering scheme as part of the national action plan to reduce the risk and harm of dog attacks.

We were successful in applying for the first round of funding last year. As a result, we will use the funding to advance our programme of neutering menacing dogs wherever possible. Owners who have found cost a barrier will now be able to have the operation on their dog subsidised through this scheme. The neutering scheme will enhance our current programmes of subsidised registration and microchipping.

**For further details please call Ross Connochie on 03 543 8400.**



# QUEEN STREET UPGRADE



BUILDING A VIBRANT AND RESILIENT RICHMOND • BEGINS FEBRUARY 2017

## What you need to know

This is a major piece of work and there is no quick and easy way to do it. It will be carried out in stages, beginning in February 2017 and running through to 1 December 2017 when work will halt for the summer. Work will restart in February 2018 and is expected to be complete by the end of April 2018.

Stage one is the section of street from Gladstone Road to Noel Leeming.

Unfortunately there will be disruption and inconvenience to street occupiers and users. We ask for your patience – the end result is a long-term fix that will benefit everyone.

### Street access

Parts of the street will be closed to traffic. Day-time pedestrian access to all shops will be maintained.

The key things to remember are:

- Use the ring road.
- Park and walk to Queen Street.
- Support retailers and businesses – they are open throughout the project.

### Bus services

Bus services will continue and the timetable will not change. However, the existing bus stop will shift from Sundial Square to the top of Queen Street opposite the Tasman District Council office.

### A new design

As each stage of the upgrade is completed, the new street design will be put in place.

The wider footpaths, narrower traffic carriageway and continuous smooth surface with no kerb and channel will contribute to slower traffic speeds and create a safer, more accessible and more pedestrian-focused space.

## Bus route change

From 1 February 2017, during the Queen Street Infrastructure Upgrade Project, there will be changes to bus stop locations in central Richmond.

The existing Queen Street and Sundial Square bus stops will be unavailable, and replaced by a new bus stop on Queen Street outside the Warehouse, opposite Tasman District Council offices, as shown on the map below.



## Ring road and car parks

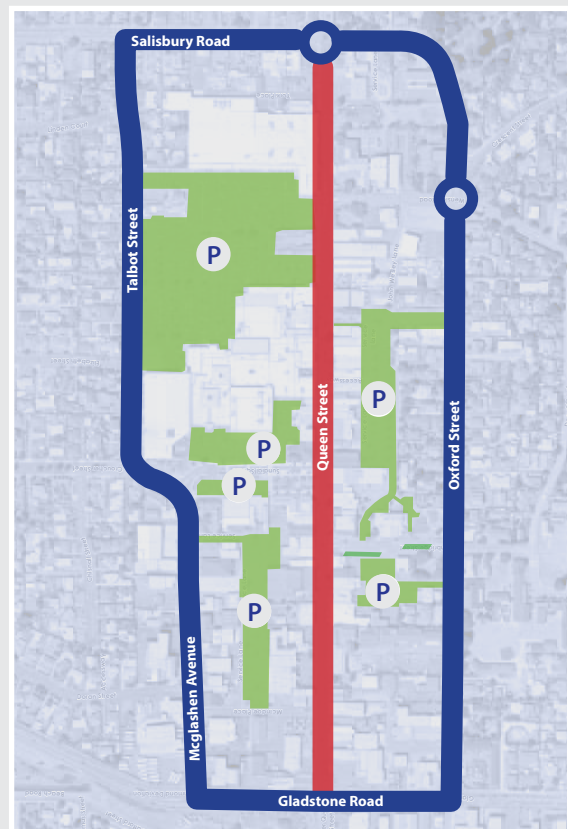

# Queen Street Upgrade – Indicative work staging

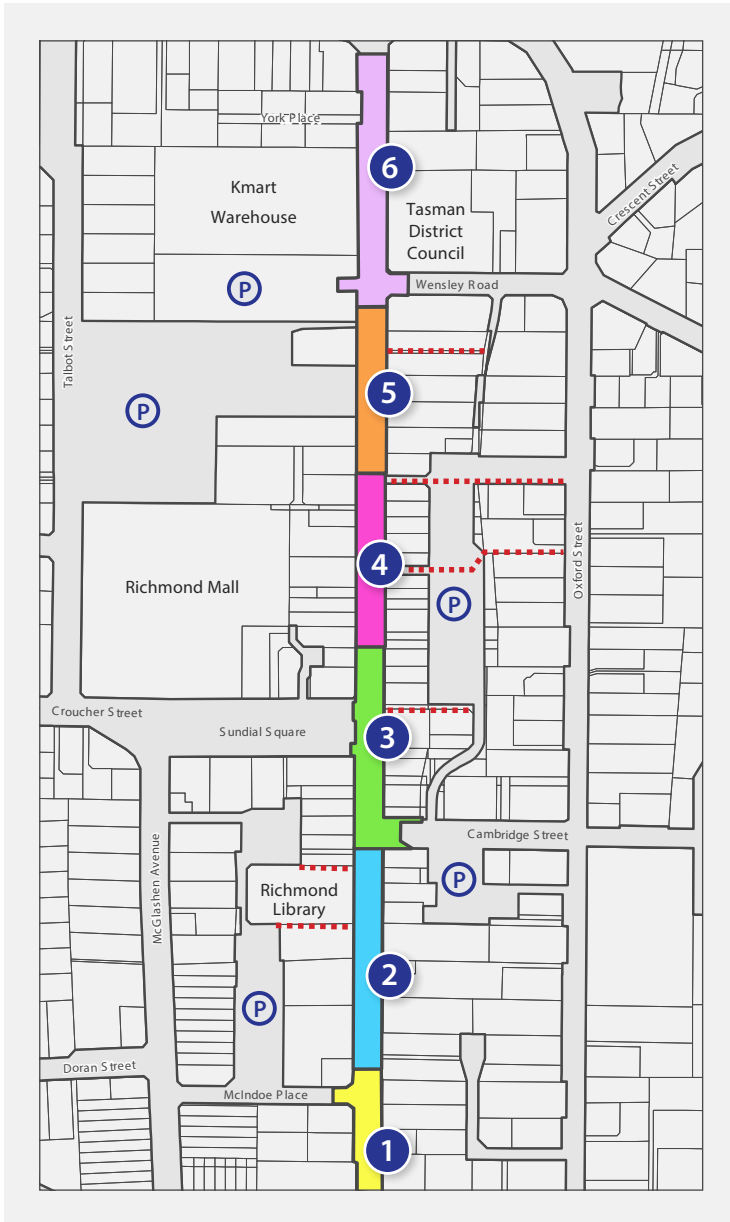

## The timeline

- 1 7 February 2017 – Mid May 2017
- 2 Mid April 2017 – Mid July 2017
- 3 Mid June 2017 – End September 2017
- 4 End August 2017 – Mid November 2017
- 5 Mid October 2017 – 1 December 2017
- 6 6 February 2018 – 30 April 2018

## Map legend

- Existing road
- Public carpark
- Pedestrian links
- Work stage



FOR MORE INFORMATION ON THE QUEEN STREET UPGRADE  
VISIT [WWW.TASMAN.GOV.TZ/QUEEN-STREET](http://WWW.TASMAN.GOV.TZ/QUEEN-STREET).

## DEERE SEASON

SALES EVENT

## GREAT OFFERS ON NOW!



**SIDE DISCHARGE RIDE-ON MOWERS**

**FROM ONLY \$3,300 incl GST**  
RRP \$3,650 incl GST



**REAR CATCHER RIDE-ON MOWERS**

**FROM ONLY \$4,400 incl GST**  
RRP \$4,880 incl GST



**ZERO TURN RIDE-ON MOWERS**

**FROM ONLY \$4,700 incl GST**  
RRP \$5,060 incl GST

Gordon Handy  
Machinery Ltd

Farlands  
CO-OPERATIVE  
CARD ACCEPTED HERE

**Ph: 03 543 8041**  
70 Gladstone Road,  
Richmond

**JOHN DEERE**

[www.gordonhandy.co.nz](http://www.gordonhandy.co.nz)

# Help us get it right – current consultations



Mapua wharf sunset

The conversations we have with the community are ongoing as we work together to shape the future of our district. Here's the proposals we're seeking your feedback on at the moment.

## Takaka freshwater proposals

The Takaka Freshwater and Land Advisory group (Takaka FLAG) was set up to provide recommendations to the Council on how to manage freshwater allocation and water quality in the Takaka catchments.

The proposals seek good management practice by all rural and urban water users, including management of on-site wastewater and stock access to water bodies. Promotion and support of stream restoration is also a key focus. FLAG has been working on proposals for some time and wants your feedback on proposed approaches.

### Find out more

You can read about the FLAG's work and proposals on the Council's website. Visit [www.tasman.govt.nz/link/TakakaFLAG](http://www.tasman.govt.nz/link/TakakaFLAG).

Over the next few months, the FLAG and Council staff will discuss the proposed water management approaches with iwi, water users and the local community before FLAG makes their recommendations to the Council later in the year.

## Mapua waterfront

How would you like the Mapua waterfront area and surrounds to look in the future?

We want your ideas on the Mapua waterfront and nearby areas. This information will guide future decision making on use of land, the amount and type of infrastructure, and funding needs in the Mapua waterfront and surrounds. It will focus on Council-owned land primarily as this is the area we have most influence over (Waterfront Park, Mapua Wharf, remediated commercial and residential land, and Grossi Point).

View a map of the area and take the survey at [www.tasman.govt.nz/feedback](http://www.tasman.govt.nz/feedback). The survey closes 13 February 2017.

## Help us plan for the future of Motueka's parks, playgrounds and sportsfields

The management of Motueka's many and varied public reserves is due for a refresh – and we need your help to bring it up to date. Please let us know which reserves you use regularly, what you value most about them, and any changes you would like to see to the way they are used or managed.

Have your say at [www.tasman.govt.nz/feedback](http://www.tasman.govt.nz/feedback).

## Draft Stephens Bay esplanade reserve plan

Work to improve public access to the Stephens Bay Esplanade Reserve and provide a connection to Tapu Bay is underway.

The draft works plan proposes to construct a 1.5 metre wide gravel pathway from the end of Anarewa Crescent which links to Anarewa Point and Tapu Bay Reserve, establish coastal native plants on much of the reserve area and install three seats at selected locations.

The walkway path alignment, views across the reserve to the coast and buffer plantings to maintain privacy will be developed working with individual neighbours.

Stage one will be to construct the gravel walkway path and install signage. Stage two will cover the establishment of new plantings and installation of three seat/tables. These plantings will be carried out over three planting seasons.

See the draft plan and have your say at [www.tasman.govt.nz/feedback](http://www.tasman.govt.nz/feedback).



## TASMAN'S TOP TREE TEAM

Nelmac Tree Care is #1 in the top of the south.

Call us for a free quote for: canopy reduction, tree removal, pruning, hedges & all tree work.

0800 635 622







## New rules for fencing pools

There are new pool fencing regulations from the start of this year as the Fencing of Swimming Pools Act 1987 has been replaced by the Building (Pools) Amendment Act 2016. All swimming pools more than 400mm deep require consent.

### What does that mean for me?

New pools or pool barriers will have to meet the consent requirements to restrict access to the pool area by children under 5 years old.

In some cases, small heated pools less than five square metres no longer require a fence, as a safety cover locked into place when not in use is now an acceptable barrier.

All pools are required to be registered and must be inspected every three years.

### Come and talk

If you have any questions about the new regulations, or the suitability of pool barrier options, we suggest meeting with the duty building consent officer to talk it over.

---

**More information available at [www.tasman.govt.nz/link/private-pools](http://www.tasman.govt.nz/link/private-pools).**

---

## Warning for toxic algae in Waimea and Wai-iti rivers

The presence of toxic algae has grown recently in Tasman's Waimea and Wai-iti rivers.

The latest results showing the algae's growth to warning levels following a number of weeks with relatively low levels of growth.

Regular river users who take dogs or toddlers down to play in the water are strongly advised to become familiar with what the toxic algae looks like and avoid contact when it is present.

The algae that is of most concern is distinctive, forming mats that are soft, dark coloured (black, dark green or dark brown), sometimes thick (over 5mm) and somewhat jelly-like.

We will place warning signs at the most popular sites if the algae reaches levels exceeding 20%. We keep a close eye on rivers for toxic algae during the summer months and post results to our website regularly. See [www.tasman.govt.nz/link/toxic-algae](http://www.tasman.govt.nz/link/toxic-algae) for the latest results.

---

**If you are concerned about toxic algae or wish to report a site where algae is present, please contact us any time on Ph. 03 543 8400. A photo of the algae and/or the site would also be helpful.**

---

## POOL OWNERS CHECKLIST

---

If you have a swimming pool on your property, you can expect an audit visit approximately every three years. In between audits, you can do your own regular checks to ensure your pool is safe and secure and complies with regulations.

- ✔ My pool has a physical barrier that restricts access to children under 5 years old.
- ✔ My pool gates open away from the pool, self-close and have a child proof latch.
- ✔ I have a backflow preventer on the tap used for filling the pool.
- ✔ I don't have anything climbable outside the pool barrier.
- ✔ I only have pool-related activities in the pool area. (It's not a good place to plant my vegetable garden or store the kids' toys).

Remember that 'take home and pop up' pools with a water depth of over 400mm must meet the requirements of the legislation.

On 1 January 2017, the Fencing of Swimming Pools Act 1987 was replaced with the Building (Pools) Amendment Act 2016.

For more information visit [www.tasman.govt.nz](http://www.tasman.govt.nz), or contact Council's Duty Building Consent Officer. If you have questions please contact us on Ph. 03 543 8400.

# NEWSLINE UPDATES



KEEPING YOU INFORMED ABOUT NEWS AND EVENTS IN THE TASMAN DISTRICT • 27 JANUARY 2017

## Public notices

### Holiday closures

Tasman District Council offices and libraries will be closed on Monday 30 January for Nelson Anniversary Day and Monday 6 February for Waitangi Day.

For urgent or emergency issues you can contact the Council 24 hours a day on 03 543 8400. You can also phone your local Council Service Centre number.

### Golden Bay outstanding natural features and landscapes

Feedback originals and summaries from last year's public consultation process on the Draft Plan Change have been uploaded onto the Tasman District Council website. The webpage link is: [www.tasman.govt.nz/link/goldenbaylandscapeproject](http://www.tasman.govt.nz/link/goldenbaylandscapeproject).

Hard copies of feedback originals and summaries will be also available at Council service centres.

**24 HOUR ASSISTANCE:  
PHONE YOUR LOCAL  
SERVICE CENTRE:**

**RICHMOND** 03 543 8400

**MURCHISON** 03 523 1013

**MOTUEKA** 03 528 2022

**TAKAKA** 03 525 0020

### Affordable Professional Funerals

We can provide every service and option, and leave you with memories of a lifetime of love.

**03 544 4400 • [www.wrfs.co.nz](http://www.wrfs.co.nz)**



**WAIMEA RICHMOND  
FUNERAL SERVICES**

### Expressions of interest – campground manager relief

We are seeking expressions of interest from couples who have the ability to fulfil the requirements and are available at short notice to be relief campground managers at Council-owned campgrounds. Any relief work will be on a casual basis with no certainty as to the length and frequency of the work. If you are interested and capable of filling the role so our permanent camp managers can have the occasional break please email [flo.sanjose-co@tasman.govt.nz](mailto:flo.sanjose-co@tasman.govt.nz). To be successful in your application you will have relevant experience and strong references.

### Public Notice of alcohol licensing applications

Applications for new and renewed alcohol licences are publicly advertised on the Council website. The use of a website for public notices is allowed under the Sale and Supply of Alcohol Act, and is good for the community and for businesses. The public notices remain accessible to everyone online and there are also links and information for people wanting to object to an application. Site notices will still be displayed on the premises to alert the public to an application.

Public notices of applications can be viewed at [www.tasman.govt.nz/link/alcohol-licensing-applications](http://www.tasman.govt.nz/link/alcohol-licensing-applications).

### Night Noodle Market

**Saturday 11 February 2017, 4.00 pm – 9.00 pm at Washbourn Gardens, Richmond.**

Tasman's first night Noodle Market comes to Washbourn Gardens in February; a chance to sample a range of delicious ethnic dishes and celebrate our unity in diversity. The Noodle Market, organised by the Nelson Multicultural Council, will have 20 food stalls, family-friendly entertainment, music and lanterns. Free entry.

### Upcoming maritime events

#### Waka Ama Event Reservation and speed limit uplift

The Maitahi Outrigger Canoe Club will be holding a regatta at Lake Rotoiti between 4.00 pm and 8.00 pm on Friday 10 February and between 8.00 am and 5.00 pm on Saturday 11 February 2017.

- Other lake users are encouraged to use the ramp and beaches of West Bay for access during the event.
- People wishing to waterski should perform deep water starts outside the reserved area while the reservation is in force.
- Powered vessel operators are also reminded to give way to Waka Ama and avoid causing unnecessary risk with vessel wakes outside of this area.

#### Other events

- 4 and 5 March, Classic Boat Show Lake Rotoiti.
- 1 and 2 April, Power Boat Regatta Lake Rotoiti.

Due to Navigation Safety requirements, water users not involved in these events may be excluded from defined areas during these activities. Notices will be placed at nearby access points in advance.

Further details for these and any new events are online [tasman.govt.nz/link/maritime-events](http://tasman.govt.nz/link/maritime-events).

### Motueka pool closed for public swimming

Sport Tasman advises that due to poor water visibility at the Motueka High School Pool, the pool will not reopen for the summer for public swimming. It stressed that this is a visibility issue and not necessarily a water quality issue. Staff have to be able to see the bottom of the pool to provide safe supervision, and at times this has not been possible. Other users, such as the Motueka Swimming Club and early morning lane swimmers may still use the pool.



# NEWSLINE UPDATES



KEEPING YOU INFORMED ABOUT NEWS AND EVENTS IN THE TASMAN DISTRICT • 27 JANUARY 2017

## Road closures

### Notice of road closure

**Applicant:** National Advanced Drivers School.

**Event:** Driver training.

**Location of road closure:** Marchwood Park Road (from Queen Victoria Street to Marchwood Park gates).

**Date of road closure:** 20, 21, 22, 29, 30, and 31 March 2017. 10.00 am – 11.00 am, 12.00 pm – 1.00 pm, 2.30 pm – 3.30 pm on each date.

**Objections close:** Monday 20 February 2017.

### Notice of road closure

**Applicant:** Richmond Unlimited.

**Event:** Sprig & Fern Summer Harvest Fare 2017.

**Location of road closure:** Croucher Street and Sundial Square carpark.

**Date of road closure:** Friday 17 March 2017. 2.00 pm – midnight.

**Objections close:** Friday 17 February 2017.

## How to make an objection

If you would like to object, just write to us. Please include the applicant name and the date of the event and your reasons for objecting. 189 Queen Street, Private Bag 4, Richmond, Nelson 7050. Phone 03 543 8400, Fax 03 543 9524 or email: [info@tasman.govt.nz](mailto:info@tasman.govt.nz)

## Resource consents

The Council has received applications for resource consent, which have been publicly notified in The Nelson Mail. The applications and supporting information may be examined at any Council office. The full public notice may be found online at our website [www.tasman.govt.nz](http://www.tasman.govt.nz). Any person may make a submission on the applications in accordance with Section 96 of the Resource Management Act 1991. Submission forms are available from Council offices and on our website. Please note that the following is an abridged advisory notice only.

**Applicant:** Eastwood Hill Limited

**Location:** 382 Pomona Road, Ruby Bay

**Consent Type, Application Number and Proposal:** Subdivision (Application RM160369)

To subdivide an 8.46 hectare allotment in the Rural 3 Zone to create eight lots (Lots 1-7 and 9), with areas varying in size between 0.34 hectares and 5.7 hectares.

**Land Use (Application RM160437)**

To erect a dwelling on each of proposed Lots 1–7.

**Earthworks (Application RM160436)**

For earthworks associated with the construction of rights of way, building platforms, vehicle accesses and a stormwater detention pond.

To disturb soil that is subject to the National Environmental Standard (NES) for Assessing and Managing Contaminants in Soil to protect Human Health.

**NES (Application RM160550)**

To subdivide land that is subject to the National Environment Standard (NES) for Assessing and Managing Contaminants in Soil to protect Human Health.

**Stormwater Discharge (Application RM160426)**

To discharge stormwater from the right of way and building sites to land.

**Wastewater Discharges (Applications RM160427–RM160435)**

To discharge wastewater to land on each of Lots 1–7, with reserve disposal fields for Lots 2–7 to be on proposed Lot 1.

**Stormwater Discharges (Applications RM160551–RM160557)**

To discharge stormwater from each of proposed Lots 1–7.

The application site is within the Rural 3 Zone as defined in the Tasman Resource Management Plan.

**Submissions due: 4.30 pm on Monday 20 February 2017.**

## SHOWHOME EXTRAVAGANZA



\* 2 Stedyl Crescent, Richmond

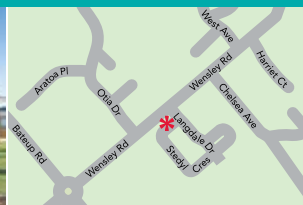

\* **SHOWHOMES**  
2 & 4 Stedyl Crescent  
Richmond  
OPEN Monday to Friday  
11.00am–4.00pm  
Saturday & Sunday  
1.00pm–4.00pm



\* 4 Stedyl Crescent, Richmond

G.J. Gardner Homes are acknowledged for their innovative design concepts. Our designers are continually coming up with fresh ideas and creative living plans. Here's your chance to view some of their latest ideas incorporated into a stunning new designer showhomes. Design innovation is just one more reason why more people build with G.J. Gardner Homes every year than any other builder.

Phone 03 543 9502  
0800 42 45 46 [www.gjgardner.co.nz](http://www.gjgardner.co.nz)

NELSON OFFICE 195 Queen Street, Richmond  
OPEN Monday to Friday 8.00am–5.00pm

**G.J. Gardner. HOMES**





# WRITE CHOICES

FROM THE TASMAN DISTRICT LIBRARIES



## Holiday closures

We hope you're enjoying a wonderful summer and finding time to chill out and relax with good books, magazines, music and DVDs. All Tasman libraries are closed on Anniversary Day – Monday 30 January and on Waitangi Day – Monday 6 February. Visit your local library today and stock up on your reading, listening and watching so you're set for the two long weekends.

## Book groups

Would you like to get together with other avid readers to discuss what you've all been reading? Maybe one of our library book groups is what you're looking for. Rather than focussing on a set book each month, everyone shares whatever they've been reading over the past few weeks. It's a great way to find new books and authors to try. Richmond, Motueka and Takaka libraries all run monthly book group meetings. You'll find the meeting dates on the library website Featured Events page. Make 2017 your year of reading.

## Tiny Tots is back

Back to school means that our popular Tiny Tots sessions are back. Under 3s and their carers can enjoy stories, songs, rhymes and active movement. These fun sessions are free and run weekly during term time at Richmond, Motueka and Takaka libraries. Find details of dates and times on the library website Featured Events page.

## Mystery Ink at Richmond Library

Mystery Ink, Richmond Library's teens-only group, is meeting on Thursday 9 February from 3.30 – 4.30 pm. There will be food, games and new books to enjoy. All keen teen readers are welcome!

## Visualise your goals at Motueka Library

Start the year by learning how to visualise your aspirational goals and create a vision board to help you make them come true. Motivational speaker Angela Cheruseo will be at Motueka Library on Thursday 23 February from 6.00 pm to talk about how you can make your dreams a reality. Angela's talk will be followed by a vision board workshop. Bookings are essential. Cost: \$5.00. Phone 03 528 1047 or call into Motueka Library to book your place.

## Most popular reads of 2016

No surprises that the library's most popular author award goes to Lee Child for another year. The appeal of hero Jack Reacher shows no signs of decreasing anytime soon. Nora Roberts also hit our top ten again. The re-release of her early books has kept her fans well-supplied. Other popular authors were Lesley Pearse with A Lesser Evil and Gypsy among your top reads, Jodi Picoult with Sing You Home, Ann Cleeves with Hidden Depths and Jojo Moyes with The One Plus One.

Pieces of Blue by Kerry McGinnis, the story of her childhood as a drover's daughter in outback Australia, was the most popular non-fiction book of 2016.

Scandinavian movie As It Is In Heaven was the most popular DVD Film for 2016. The TV adaptation of PD James' Death in Holy Orders was the most popular TV series with Anne of Green Gables a close second.

If you're looking for new authors to read this year remember to check out our e-resource Who else writes like ...? Or ask our helpful staff on your next visit to your local library. And if you want to know what's new in the library click the New in the Libraries button next time you use the library catalogue.

## Romantic poetry competition

This February at your library it's all about love, romance and relationships – the highs and the lows. As part of getting all romantic, we're running our first ever romantic poetry competition.

All you have to do is write an original love poem that fits into one of these four categories – best love poem about your library, best romantic poem, best love poem about a pet, best love poem about a political figure – and either drop it into your library or email it to [library@tasman.org.nz](mailto:library@tasman.org.nz). Please include your name, contact details and the category of your poem with your Romantic Poetry Competition entry so that we can get in touch with you if you're a winner in one of the four categories. If emailing your entry, please add Romantic poem competition in the subject line. The competition is open to anyone over the age of 16 and closes on 28 February. Terms and conditions apply and are available at your library.

Keeping our Homes, Businesses and Public Places Clean & Safe

Wishing Our Loyal Customers  
*Best Wishes for 2017*

Start a New Year with a **Clean Tank ...**

**Book Online** to have your Septic Tank Emptied

[www.nmwaste.co.nz](http://www.nmwaste.co.nz)

Freecall 0800 725 326 • [malcolm@nmwaste.co.nz](mailto:malcolm@nmwaste.co.nz)



NELSON  
MARLBOROUGH  
WASTE

LOCALLY OWNED & OPERATED