

**NOTES:**

1. CADASTRAL BOUNDARIES ARE INDICATIVE ONLY. BOUNDARIES TO BE VERIFIED BY SURVEY.
2. ALL DIMENSIONS IN METRES UNLESS OTHERWISE NOTED.
3. ALL LEVELS ARE IN TERMS OF MEAN SEA LEVEL.
4. ALL CO-ORDINATES ARE IN TERMS OF NELSON CIRCUIT NZGD 2000.
5. PIPES, CABLES AND OTHER UTILITIES, FOUNDATIONS, LEVELS, REFERENCE MARKS AND OTHER OBSTRUCTIONS INDICATED ON THIS DRAWING ARE BASED ONLY ON READILY AVAILABLE RECORD PLANS AND OTHER INFORMATION. THIS INFORMATION MAY NOT BE COMPLETE, ACCURATE NOR UP TO DATE PRIOR TO CARRYING OUT ANY EXCAVATION OR OTHER PHYSICAL WORK. CONTRACTORS SHALL OBTAIN THE LATEST INFORMATION FROM UTILITY PROVIDERS AND CARRY OUT DETAILED EXPLORATORY WORK, TRACING, LOCATING, PROTECTION, ISOLATION AND ALTERATIONS AS ARE REQUIRED UNDER NZS 3910 (CLAUSE 5.13).
6. ALL PAVEMENT MARKINGS AND SIGNAGE TO MEET THE REQUIREMENTS OF NZTA MANUAL OF TRAFFIC SIGNS AND MARKINGS (MOTSAM PARTS 1 AND 2).
7. LOCATION OF NEW POWER AND TELECOM CABLE NOT SHOWN ON PLAN - SEE TYPICAL CROSS SECTION FOR DETAILS.

ORIGINAL SIZE A1  
DO NOT SCALE - IF IN DOUBT, ASK



CURVE NO.	1
RADIUS (M)	99.00
SPIRAL LENGTH IN (M)	
ARC LENGTH (M)	52.50
SPIRAL LENGTH OUT (M)	4.00
WARP RATE IN (%/SEC)	3.50
SUPERELEVATION (%)	8.00
WARP RATE OUT (%/SEC)	3.20
DESIGN SPEED (KM/HR)	65.00
CURVE WIDENING (M/LANE)	0.30

CURVE NO.	2
RADIUS (M)	67.00
SPIRAL LENGTH IN (M)	35.00
ARC LENGTH (M)	95.20
SPIRAL LENGTH OUT (M)	35.00
WARP RATE IN (%/SEC)	2.70
SUPERELEVATION (%)	8.00
WARP RATE OUT (%/SEC)	3.50
DESIGN SPEED (KM/HR)	55.00
CURVE WIDENING (M/LANE)	0.00

CURVE NO.	3
RADIUS (M)	67.00
SPIRAL LENGTH IN (M)	35.00
ARC LENGTH (M)	86.90
SPIRAL LENGTH OUT (M)	35.00
WARP RATE IN (%/SEC)	3.50
SUPERELEVATION (%)	8.00
WARP RATE OUT (%/SEC)	3.50
DESIGN SPEED (KM/HR)	55.00
CURVE WIDENING (M/LANE)	0.00

CURVE NO.	4
RADIUS (M)	0.00
SPIRAL LENGTH IN (M)	0.00
ARC LENGTH (M)	
SPIRAL LENGTH OUT (M)	
WARP RATE IN (%/SEC)	
SUPERELEVATION (%)	
WARP RATE OUT (%/SEC)	
DESIGN SPEED (KM/HR)	
CURVE WIDENING (M/LANE)	0.00

**LEGEND:**

- PROPOSED KERB AND CHANNEL
- PROPOSED BATTER SLOPES
- PROPOSED FENCE
- EXISTING ROAD BOUNDARY
- EXISTING CENTRELINE
- EXISTING UNDERGROUND TELECOM
- EXISTING UNDERGROUND WATER
- EXISTING FENCE
- EXISTING TOP OF BANK
- EXISTING SURVEY MARK
- EXISTING POWER POLE
- EXISTING TELE COMMUNICATIONS
- EXISTING SIGN
- PROPOSED SIGN

OPTION 1  
INITIAL DESIGN

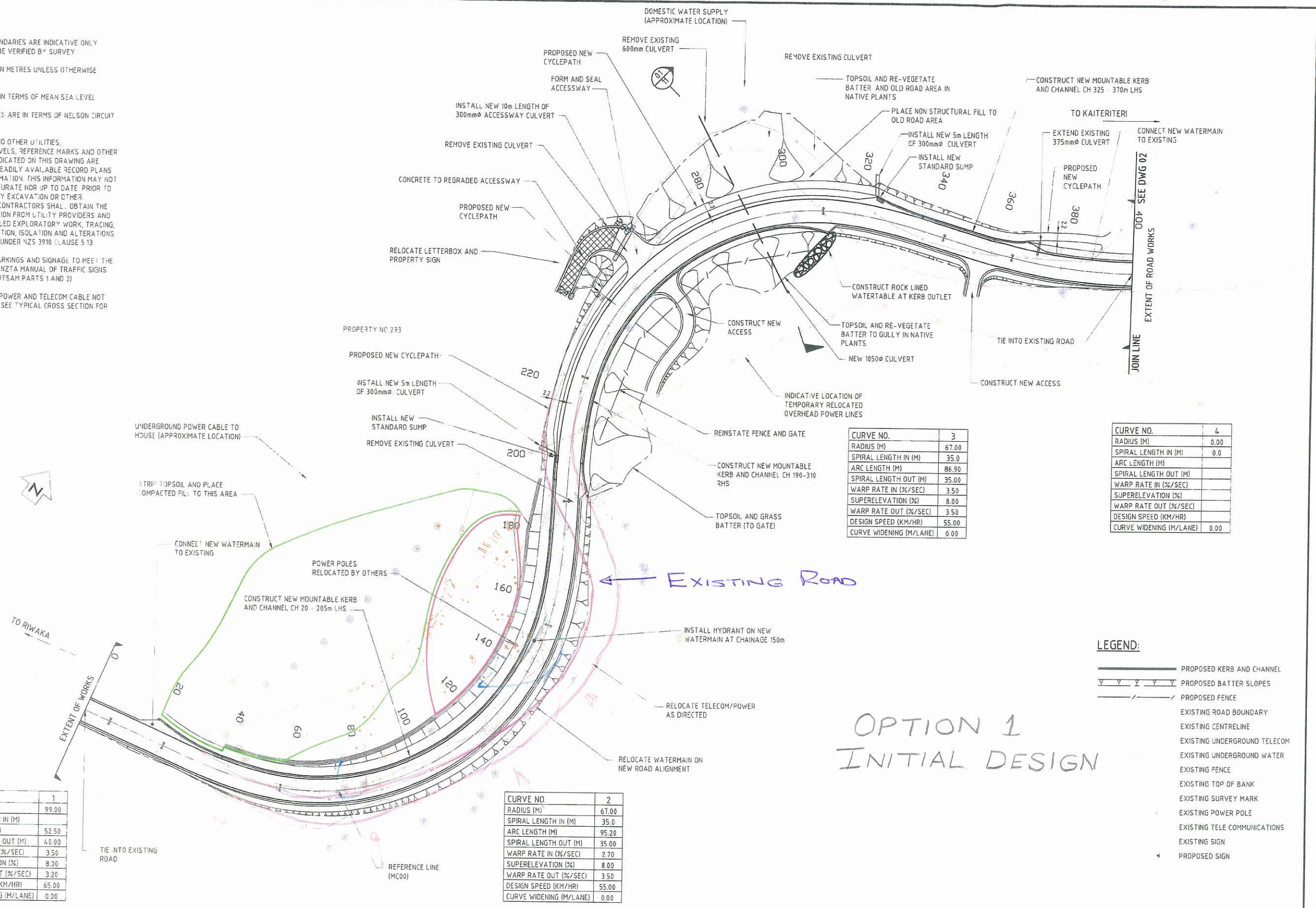

<p>1 FOR CONSTRUCTION</p> <p>0 FOR TENDER</p> <p>B FOR APPROVAL</p> <p>A FOR CONSULTATION</p>	<table border="1"> <thead> <tr> <th>REV</th> <th>DESCRIPTION</th> <th>DATE</th> </tr> </thead> <tbody> <tr> <td> </td> <td> </td> <td> </td> </tr> </tbody> </table>	REV	DESCRIPTION	DATE				<table border="1"> <thead> <tr> <th>FIELDBOOK</th> <th>DESIGNED</th> <th>DRAWN</th> <th>CHECKED</th> <th>REVIEWED</th> <th>APPROVED</th> </tr> </thead> <tbody> <tr> <td>M Holyoake</td> <td>P Murray</td> <td>K Wallner</td> <td>A Davies</td> <td>R Palmer</td> <td> </td> </tr> </tbody> </table>	FIELDBOOK	DESIGNED	DRAWN	CHECKED	REVIEWED	APPROVED	M Holyoake	P Murray	K Wallner	A Davies	R Palmer		<p><b>MWH</b></p> <p><b>tasman district council</b></p> <p>ASSET ENGINEER: [Signature] Date: 06/11</p> <p>ENGINEERING MANAGER: [Signature] Date: 06/11</p>	<p><b>C807 - RIWAKA TO KAITERITERI ROAD REALIGNMENT</b></p> <p>PLAN STN 0 - 400</p>	<p><b>FOR CONSTRUCTION</b></p> <p>Date Stamp: 28/10/2011</p> <p>SCALES (A1) 1:500 (A3) 1:1000</p> <p>TDC Plan No: 6430s1</p> <p>Sheet No: 01</p> <p>Rev: 1</p>
REV	DESCRIPTION	DATE																					
FIELDBOOK	DESIGNED	DRAWN	CHECKED	REVIEWED	APPROVED																		
M Holyoake	P Murray	K Wallner	A Davies	R Palmer																			

COPYRIGHT © These drawings shall only be used for the purpose for which they were supplied. No reuse is permitted and no part of this document may be reproduced or distributed without the written permission of MWH NZ Ltd.