

Motueka Community Board Meeting 20.10.20

To: Mr Chairman + Members of The Community Board. ~~Brown Ian Williams~~

1/ When time is of essence in the preservation of life, five fighters with specialist cutting gear will now be flown to car crashes and other serious incidents in the "Top of the South". I have been speaking with Kevin O'Connor of Fire and Emergency NZ (FENZ) "Nelson Fire Station Officer" who explained this new rural rapid response initiative, meant a four person crew with equipment to free people who are trapped in a vehicle, would be flown to incidents now by Helicopter Nelson. This would also provide additional resource to volunteer brigades in isolated communities eg Murchison.

Because of our area's size and the remoteness of the region injured persons were potentially waiting a lot longer for medical assistance.

The rural rapid response partnership would occur only during the day, while accidents at night would rely on a response from road crews as helicopter pilots were unable to fly at night without "night vision goggles".

My proposal is could our Motueka Community Board consider contributing funding as a "Special Project" towards the provision of night vision goggles?

2/ In the Press Newspaper of 15.07.20 an article titled "Fire Stations set for huge cash boost" The Internal Affairs Minister Tracey Martin announced a \$57.5 mill. boost for major upgrades to Fire Stations around NZ allowing for improvement to 26 stations where some would be replaced and others partially refurbished.

Could I suggest through our Chairman to Tracey Martin that a letter be sent advising of our Highway 60/High St. upgrade and would it be opportune to include a new re-dedicated Fire Station for our "Urban Fire Fighters" in Motueka. (Is it legal to have a Fire Station on a State Highway?)

Tabled Document.

MCB 20-10-20

Many Thanks.

6 News

# Fire stations set for huge cash boost

## Canterbury

Jake Kenny

Canterbury's fire service is set to receive more than \$100 million in new station builds and improvements to existing stations.

Canterbury will receive a further \$23.8m in funding on top of the already granted \$78m for major upgrades to fire stations and jobs, Internal Affairs Minister Tracey Martin announced yesterday.

The funding includes \$12m towards building a new fit-for-purpose central city fire station on Kilmore St on its old site.

The announcement was made as part of a \$57.5m boost for major upgrades to fire stations around the country. It would allow for improvements to 26 stations, some of which would be replaced and others that required partial refurbishment, Martin said.

About \$3m has been approved to rebuild Sumner fire station, which was damaged during the Christchurch earthquakes.

Kaikōura will also receive about \$5m for a new station on a new site.

"The firefighters in Kaikōura have to respond to some fairly remote rural areas so I'm pleased that Kaikōura fire station will house both its urban and rural fire crews," Martin said.

Darfield will get \$1m for a facility to house trucks and equipment next door to its station. This would enable rural and urban fire crews to be co-located, Martin said.

The Peel Forest and Rangitata Gorge stations will receive almost \$2m for upgrades as well.

"Communities have been waiting to see the firefighters who do such a great job housed in facilities that make doing their difficult jobs just a bit easier. These projects will help our firefighters – and they will help our communities and create jobs," Martin said.

Construction of the new Kilmore St station should be completed in early or mid-2022.

The station was built in 1962 and has served as Fire and Emergency New Zealand's headquarters for the top of the South Island.

Tabled Document

MUB 20-10-20.



MUB 20-10-20  
Tabled Document

Tasman Youth Council  
Motueka, 7120  
[Tiegan.m@sporttasman.org.nz](mailto:Tiegan.m@sporttasman.org.nz)

Motueka Community Board  
Brent Maru – Chair  
7Hickmott Place,  
PO Box 123,  
Motueka, 7143  
[mcb@tasman.govt.nz](mailto:mcb@tasman.govt.nz)

### **Re: Thorp Bush Proposal**

Dear Motueka Community Board.

Firstly, we would like to say a big thank you to Councillor David Ogilvie for meeting with the Motueka Youth Council in regards to the background and history of Thorp Bush. We appreciate you giving us some of your time to educate us in the importance of this natural bush area.

In relation to this, we want to enhance the bush area and make others aware of the culture diversity, history and importance of this area. We believe this bush should be cherished, looked after and respected by the community.

With this, we would like to use the \$10,000 from Motueka Community Board for Playgrounds to help make this a special and loved place for all.

We have recognised that over time, the park has been defaced and we want to give it back some love. We believe by giving it the playground and aspects of the park a face-lift this will make the park more used by the community. Ideally, we would like to see more people utilising the park for community events, picnics and community activities.

Ideally, we would love to see a lot happen to this park but we understand due to budget this may not be achievable. We have created a three-stage progression for what we would like to see happen at Thorp Bush and we hope you will be supportive of stage one at this time.

#### **Stage one:**

- Repaint existing playground (Doc leaf green to blend with the trees)
- Replace plastic components with new brightly coloured ones. (these have been damaged and burnt in places)

#### **Stage two:**

- Create bee gardens with the hexagonal theme with social seating alongside the playground. (Currently there is only one picnic table close to the playground; Social seating will allow areas for parents to sit while watching their children).
- Tidy driveway. (we understand that the plan is to get rid of this driveway, but if it is to stay long term we would like to see interactive learning art work displayed), include primary school students consultation.
- Wheelchair ramps for main pathways that lead to driveway. (to make more accessible for woodlands residents)



Tasman Youth Council  
Motueka, 7120  
[Tiegan.m@sporttasman.org.nz](mailto:Tiegan.m@sporttasman.org.nz)

**Stage three:**

- Pathway along garden from new world access to playground.
- Extra lighting for night-time activities such as Morakau (this was suggested by Sean Delany from Te Awhina).
- Signage boards at playground targeted at kids about how important the forest area is.

Further to this, we wish to do a rubbish clean up at the park with the help of the Motueka High School environmental committee. We would also like to hold some events at Thorps Bush in March – May 2021. We also want to work with New World to look at options of removing the fence from new world carpark to open up the area.

We hope that we can work with the Motueka Community Board to complete stage one of this project in the near future.

Kind Regards

Tasman Youth Council.





MCB 20-10-20  
 Tabled Document

# Site Plan 2021

## 28th February 11am till 6pm



Walk Bridge

↑ REC CENTRE

Feb 28th 11am - 6pm

Event Coordination: ENEC, 08 908 1100

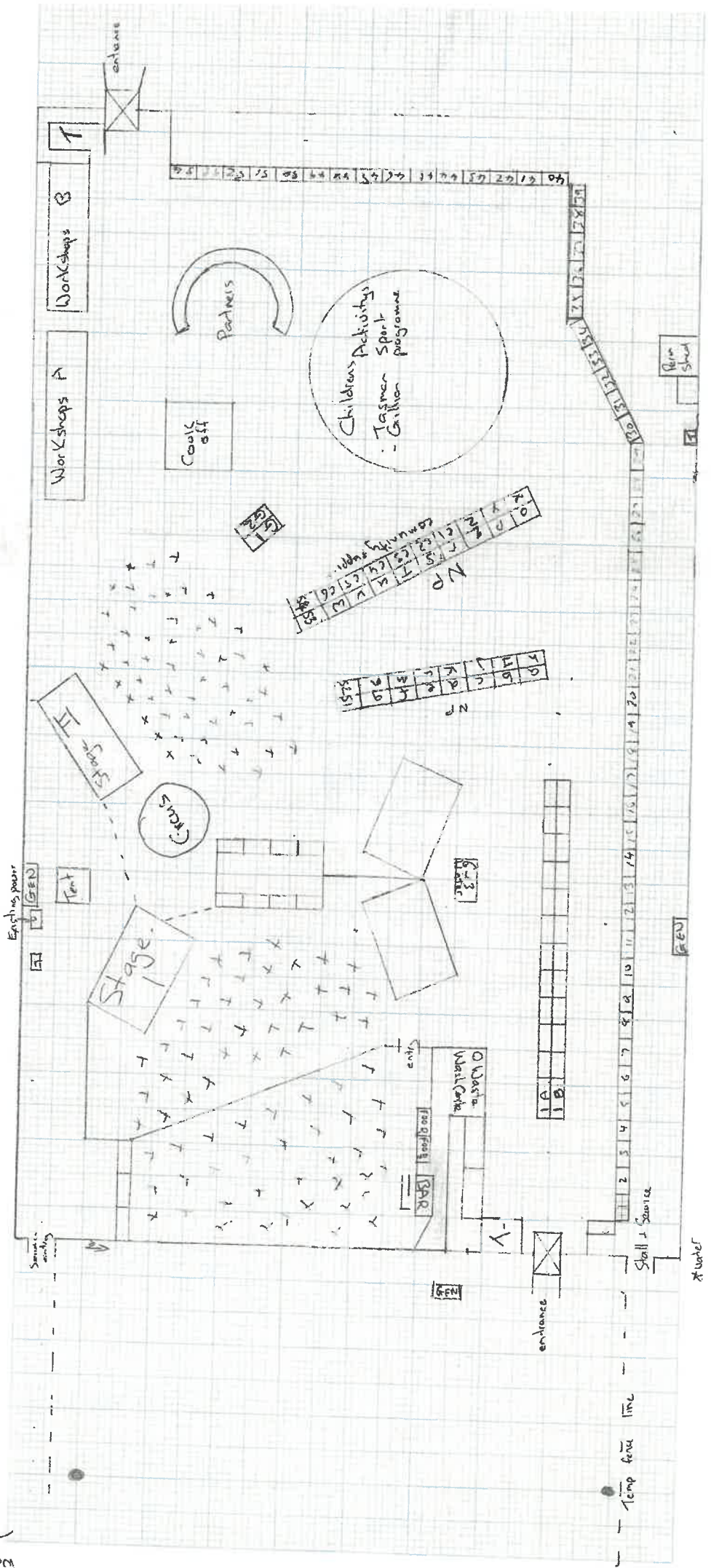



# MCB20-10-20 Tabled Document

Tasman Youth Council  
Motueka, 7120  
[Tiegan.m@sporttasman.org.nz](mailto:Tiegan.m@sporttasman.org.nz)

Motueka Community Board  
Brent Maru – Chair  
7Hickmott Place,  
PO Box 123,  
Motueka, 7143  
[mcb@tasman.govt.nz](mailto:mcb@tasman.govt.nz)

Dear Motueka Community Board.

Since our last playground review part 1 was completed, we have managed to review all of the playgrounds in the Motueka area. The Tasman Youth Council have also had a chance to work with a local group of Motueka High School students who have helped shape part of this review.

After completing part one we recognised most, if not all of our Motueka playgrounds do not cater for some of our more vulnerable tamariki and rangatahi. With the help of the Motueka High School BASE students and staff, we were able to identify items of equipment as well as flooring that could help make one of our main playgrounds more inclusive. Please find our review below.

## **Tilson Playground**

Comments: We think this playground is well presented, very neat and tidy. We believe there is nothing that needs immediate attention.

## **Ledger Ave Playground**

Comments: We think this playground is well presented. As this is one of the newer playgrounds in our community, there is nothing to report in terms of safety.

## **Eginton Playground**

Comments: Eginton park playground seems to be a well-used playground by the surrounding neighbourhood. This playground seems to be well looked after and maintained.

## **Memorial Playground**

Comments: We believe Memorial park is a great playground for younger children. This playground is complemented well by the gym equipment. Quite often, you will see young children playing on the playground whilst their parents use this outdoor gym equipment. This is a great concept.

## **Playground Equipment for children with disabilities. (Consultation attached page 3-6).**

The Tasman Youth Council would like to recommend upgrading Decks Reserve playground into an all-inclusive space. We would like to firstly propose that we install rubber matting (featured in consultation report). This flooring helps allow better access for children in wheelchairs. This also provides a softer and more even surface for child who had difficult with balance and walking on uneven surfaces.



Tasman Youth Council  
Motueka, 7120  
[Tiegan.m@sporttasman.org.nz](mailto:Tiegan.m@sporttasman.org.nz)

Secondly we would like to propose to install a Mary-go round or wheelchair swing such as the one featured at Tahunanui playground. During this consultation, we have identified that there are many children bound to wheelchairs in our community. We would like to install this piece of equipment to make them feel included whilst visiting this area. Why should they miss all of the fun?

Our reasoning behind creating Decks Reserve into an all-inclusive playground is due to the relocation of the library. We want to enhance the new library by creating a one-stop shop for students like the MHS BASE so they can visit one main place.

The Tasman Youth Council would like to help see this project through by helping apply and contributing to fund this upgrade.

With these recommendations, the Tasman Youth Council would like to acknowledge firstly how looked after these parks look. We would also like to acknowledge how respected and looked after these playgrounds are by their users. Whilst visiting all of these playgrounds there were children playing and having fun. This is great to see these community assets being used and being enjoyed by many age groups.

We hope this information can be of good use to the Motueka Community Board. Thank you for allowing us to complete this review on behalf of the Motueka Community Board. Please think of us for future community reviews and projects.

Kind Regards

Tasman Youth Council.



## Consultation with The Base Staff- Inclusive Playground Equipment- TYC Playground Review

*Present: Chris D, Alison D, Michelle H and two students  
(Alison D has offered to take notes from asking other teacher aides at The Base what they would like to see.)*

*The ideal place for playground equipment for physically disabled students is at either Memorial Park or Decks Reserve. The following report has been written after consultation with Motueka High School's Supported Learning Centre (referred to as The Base).*

The following places in Motueka show the best possible places for inclusive playground equipment for students who attend The Base.

### Memorial Park

This location is closer to school and is a well known, well-kept park in Motueka. (Refer to map below



This playground has been noted by the staff of The Base as having great accessibility to the playground in the form of pathways and clear ground, which makes this area easy for wheelchair access. Memorial Park has an existing playground and features fitness equipment too. This has been noted by The Base staff as an area that they regularly visit because of both the playground and the fitness equipment. But unfortunately this is not inclusive of all of the students that attend The Base due to their disabilities.

### Decks Reserve

This playground area used to be a place that The Base would visit, but due to Memorial Park being a closer option, they no longer visit there. However, if there were additions to the existing playground area that would be inclusive of young people with disabilities, they would be more than happy to take the extra time to get there. (refer to map below)



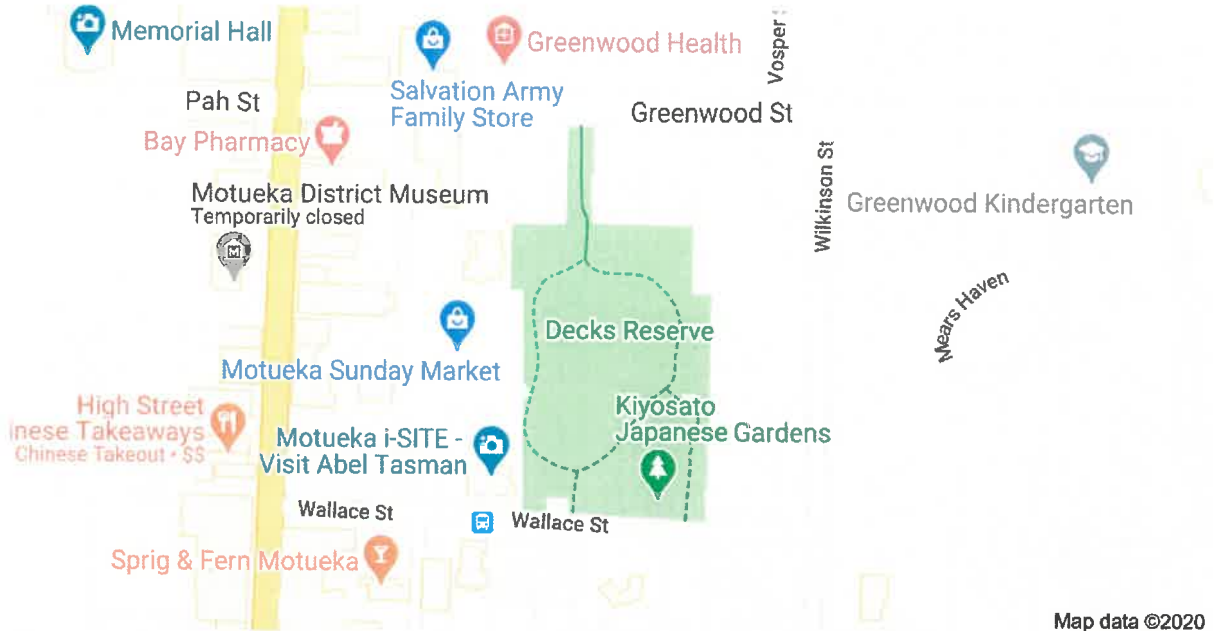

This playground has been noted by The Base staff as a great existing playground area. They have thought about future proofing an area suitable for young people with disabilities and have said that this area is also another great option for some equipment. This is because it is well-known that this will be the site for the new Motueka Library. They thought that having playground equipment for young people with disabilities would bring more people to the new library and that Decks Reserve could become an even bigger haven for all young people, no matter their physical abilities.



**Ideas for Inclusive Playground Equipment.**

1. Wheelchair accessible swing. (Image to the right)

This option has been suggested by the staff at The Base as being one of the best options for playground equipment for the physically disabled. This is because, “it gives them the biggest sense of freedom.” This option has already been seen in the Nelson/Tasman area in the Tahunanui Beach Playground. This piece of equipment suits young people who are in a wheelchair best.

2. Wheelchair accessible 'roundabout' (Image to the right)



This playground equipment was also described by the staff at The Base as another option for inclusive playground equipment. They noted that this would also be a great investment for young people without physical disabilities too because, unlike the swing option, this can be used by all.

3. Flooring (Images below)

One of the biggest concerns of the staff at The Base is the type of surface that a wheelchair can be moved on. As noted above, the pathways in Memorial Park show great accessibility for young people in wheelchairs. However, underneath playgrounds, there is often bark. This makes accessibility for wheelchairs almost impossible and has limited the options of playgrounds available for some students at The Base. Their solution is to place interlocking rubber mats underneath and around the playground. This is a better option than hard concrete and is also common in other playgrounds. The soft nature of the flooring would make the staff and students of The Base feel safer in an inclusive environment because any falls would be less harmful than concrete or grass.



Conclusion

The staff at The Base are grateful that the TYC is interested in making Motueka Playgrounds accessible for all. They said that even one of the options above would be amazing, and realistic, for the TYC to explore. The above options would help make Motueka a more inclusive place and would help young people with disabilities feel welcome to our area.

**Submission to the Motueka Community Board**

**From John & Rose O'Sullivan**

**5 and 41 Talisman Heights, Little Kaiteriteri**

**Speed Limits, Parking and Anti-Social behaviour in Little Kaiteriteri**

**Board members**

Over the last 3 years the situation regarding parking, speeding and anti-social behaviour in Rowling Road, Torlesse Drive and Talisman Heights has markedly worsened.

***Parking***

Since the parking area at Kaiteriteri for boat trailers is no longer available we have had a surge in boat trailers being parked on Rowling road, on both sides of the road making it difficult for residents from Torlesse Drive upwards to negotiate their way home. We would like to suggest that the Council make it illegal to park on one side of the road as has been the case from the bridge at Kaiteriteri.

***Speeding***

The incidents of speeding through this whole area is getting out of hand. Some people towing trailers and boats are travelling at dangerous speeds for the area which is residential. As Rowling Road is the main access way to Little Kaiteriteri Beach there are often large numbers families walking to and from the beach and the situation with the speeding vehicles is becoming increasingly more dangerous. We would like to suggest that the Community Board considers the installation of a series of speed humps along Rowling Road at regular intervals.

***Anti-Social behaviour***

Since the development of the balance of Talisman Heights into sections the area has become the target of anti-social louts driving erratically and very dangerously throughout the area. They are targeting those as yet undeveloped sections for burnouts and they also congregate up there and indulge in unacceptable activities. We would like the Community Board to consider a continuation of the speed bumps up Torlesse Drive and along Talisman Heights in an effort to discourage these hoons from coming into our area. Talisman Heights in particular, during the summer, is populated with families with a large number of younger children. The safety of these children is of no consequence to these hoons.

In conclusion, if something isn't done about these aforementioned situations an accident with serious consequences is inevitable. I urge the Community Board to seriously consider this submission.

## Project Kokiri progress update webinar, 8th October -- Destination Management Plan

1. "The Nelson Tasman Adventure Challenge was designed to get locals (and visitors) out exploring the region, supporting local businesses, spending time with loved ones and enjoying their backyard. The promotion ran across the school holidays, with \$8,000 worth of prizes up for grabs, and came to a close on Sunday night. In total, we had 373 teams with 836 players engaged in the challenge, resulting in a total of 4,925 submissions across the two week period. We are really pleased with how it all went, and have had many requests for another one over the summer holidays... watch this space."

2. The Food & Beverage Project. Based on the following ideas::

Rather than compete, get local producers to work together. It will encourage higher-spending, higher value visitors. Aiming to establish synergistic working groups featuring specific themes, involving businesses with a common geographical location that features infrastructure and ability to host visitors. Consumer driven product development and co-branding opportunities to truly showcase our region. Connecting F&B brand owners with their target audience. Engagement with other local initiatives to assist with export market channel development, such as through a Port Nelson hub.



## Notes from Council:- Motueka Community Board 19/10/20

- Tasman Environment Plan: Aorere ki uta Aorere ki tai  
To replace the current TRMP. There are community meetings across the District: Ngatimoti 25<sup>th</sup> Oct 10am-4pm  
Tasman 29<sup>th</sup> Oct, 4pm-7.30pm; Motueka Market 1st Nov;  
Riwaka School 12<sup>th</sup> Nov 3pm-6pm; Motueka TDC meeting room  
18<sup>th</sup> Nov, 3pm-7pm; Marahau Hall 23<sup>rd</sup> Nov, 3-30pm-7pm  
Kaitehi teri 26<sup>th</sup> Nov, 3-30pm-6.30pm.
- Poole St. speed ramp / pedestrian crossing point. Now completed
- Responsible Freedom Camping. Council's application for \$191,312 approved - camping ambassadors, camp maintenance, wastewater dumpsites etc.
- Freedom Camping Bylaw review. Amendments to the existing Bylaw include (1) Decks Reserve to provide for the new Library construction site (2) Alexander Bluff bridge area to more clearly identify the camping area.  
Submissions are open until Monday, Nov. 16<sup>th</sup>, & the Hearings on Wednesday Nov. 18<sup>th</sup>.
- Thorp St Domestic Water Main renewal.  
Approved as one of the Council's projects for the Government's Three Waters funding.
- Dog Control Bylaw - Review - Motueka.  
The Regulatory Committee supported the Board's recommendation not to proceed with the Bylaw review, until 2024
- Dog Microchipping Clinic  
In Motueka, at the Service Centre, 21<sup>st</sup> Nov 8.30am-9.30am.
- Torrent Bay sand replenishment completed.
- Tapu Bay toilet, expected by labour weekend.

②

- Sport N.Z. Rural Travel Fund.

Applications close on October 31st. For information check [tasman.govt.nz/link/grants](http://tasman.govt.nz/link/grants).

- 2020 Tasman BioStrategy Policy.

The deadline for submissions has been extended to October 31st.

Refer to [tasman.biostrategy@tasman.govt.nz](mailto:tasman.biostrategy@tasman.govt.nz)

- Nga Piko Reserve. Walkway being developed, playground & plantings.

- Domestic Water: - Parker St, New Water Treatment Plant. Tenders closed mid-September on a design & construct basis. Public announcement of successful contractor soon.

- Memorial Park: Cricket netting upgraded.

- Motueka Library. Blessing & laying of Mauri stone on Oct. 2nd. Carparking marked along Wallace St. Stop signs installed at Wilkinson St intersection. Construction underway.

- N.B. October 2020 = one year of our three year term now completed.

Plans - Projects - Proposals → Progress?

David Ogilvie  
20/10/20.

Profit and Loss	Month			Year End		
	Monthly Actual	Budget	Budget %	YTD Actual	Annual Budget	Annual Budget %
<b>REVENUE</b>						
CCB rate	8,196	8,225	100%	24,588	98,695	25%
Motueka Market	1,309	624	210%	1,929	12,683	15%
Closed Account Interest	28	74	38%	85	891	9%
<b>Total revenue</b>	<b>9,533</b>	<b>8,923</b>		<b>26,602</b>	<b>112,269</b>	
<b>EXPENSE</b>						
<b>Remuneration</b>						
Chairperson Monthly Salary	1,217	1,217	-100%	3,652	15,091	24%
Members (3)	1,826	1,866	-98%	5,477	23,153	24%
Community Board Members Reimbursements	0	370	0%	0	4,435	0%
<b>Miscellaneous</b>	<b>0</b>					
Community Board discretionary fund	3,275	2,608	126%	4,275	6,920	62%
Youth Development Fund	0	83	0%	0	1,000	0%
Community Board Special Projects	0	9,149	0%	0	52,854	0%
Community Board Expenses	0	0	0%	0	1,162	0%
Litter Cart	0	0	0%	0	5,281	0%
Motueka CB Sculpture maintenance	0	167	0%	0	1,000	0%
Cost of Elections	1,373	678	203%	1,373	1,373	100%
<b>Total expenses</b>	<b>7,691</b>	<b>9,972</b>	<b>77%</b>	<b>14,777</b>	<b>112,269</b>	<b>13%</b>
<b>Net Charges</b>	<b>1,843</b>	<b>(1,049)</b>		<b>11,825</b>	<b>0</b>	

**Year to date**

**Equity**

Opening Surplus/(Deficit) Balance 1 July 2020	120,908
Net Income Surplus/(Deficit) August 2020	11,825
<b>Closing Surplus/(Deficit) Balance 30 September 2020</b>	<b>132,733</b>

**Notes to the accounts**

**A) Discretionary fund**

Balance brought forward from 2019/20	3,301
Plus budget allocation	6,920
Available funds	10,221
Less Expenditure	4,275
<b>Remaining Balance</b>	<b>5,946</b>

**Discretionary fund expenditure**

Big Brothers Big Sisters	500
Motueka Random Acts of Kindness	405
Motueka District Christmas Dinner	500
Motueka Community House	500
Motueka Events Charitable Trust	500
Motueka Rebus Club	500
Motueka Tennis Club	420
Whenua Iti Trust	500
Motueka Women's Support	450
<b>Total expenditure to September 2020</b>	<b>4,275</b>

**B) Youth development fund**

Balance brought forward from 2019/20	2,825
Plus budget allocation	1,000
Available Funds	3,825
Less expenditure	0
<b>Remaining Balance</b>	<b>3,825</b>

**Youth development fund expenditure**

<b>Total expenditure to September 2020</b>	<b>0</b>
--	----------

**C) Special Projects**

Balance brought forward from 2019/20	85,232
Plus budget allocation	52,854
Available funds	138,086
Less expenditure	0
<b>Remaining balance</b>	<b>138,086</b>

**Special Projects Expenditure**

<b>Total expenditure to September 2020</b>	<b>-</b>
--	----------